



SPICER®

Drivetrain Systems

Spicer® 192

Planetary Rigid Axle

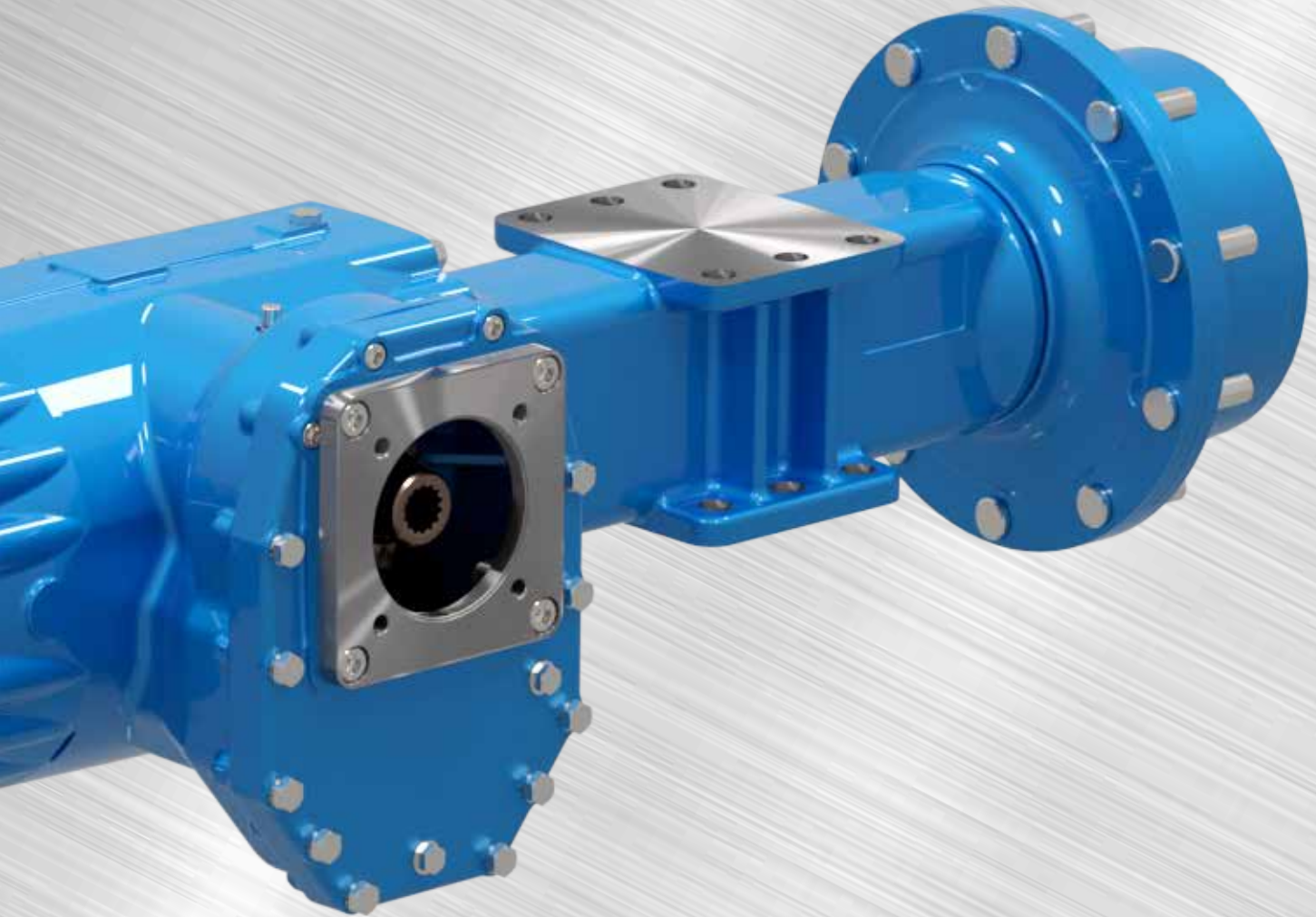

*Engineered for small- and medium-sized
single drum rollers, with **integrated**
dropbox.*

Spicer® 192

Planetary Rigid Axle with integrated Dropbox

The Spicer® 192 planetary rigid axle with integrated dropbox is designed for small- and medium-sized single drum rollers. It enables original-equipment manufacturers to reduce the package size of motors, pumps, and other hydraulic components. The use of an axle with a high reduction ratio increases the power available to the rest of the system and allows manufacturers to use more compact hydraulic components while maintaining optimal performance.

SPICER® 192 AXLE: FEATURES

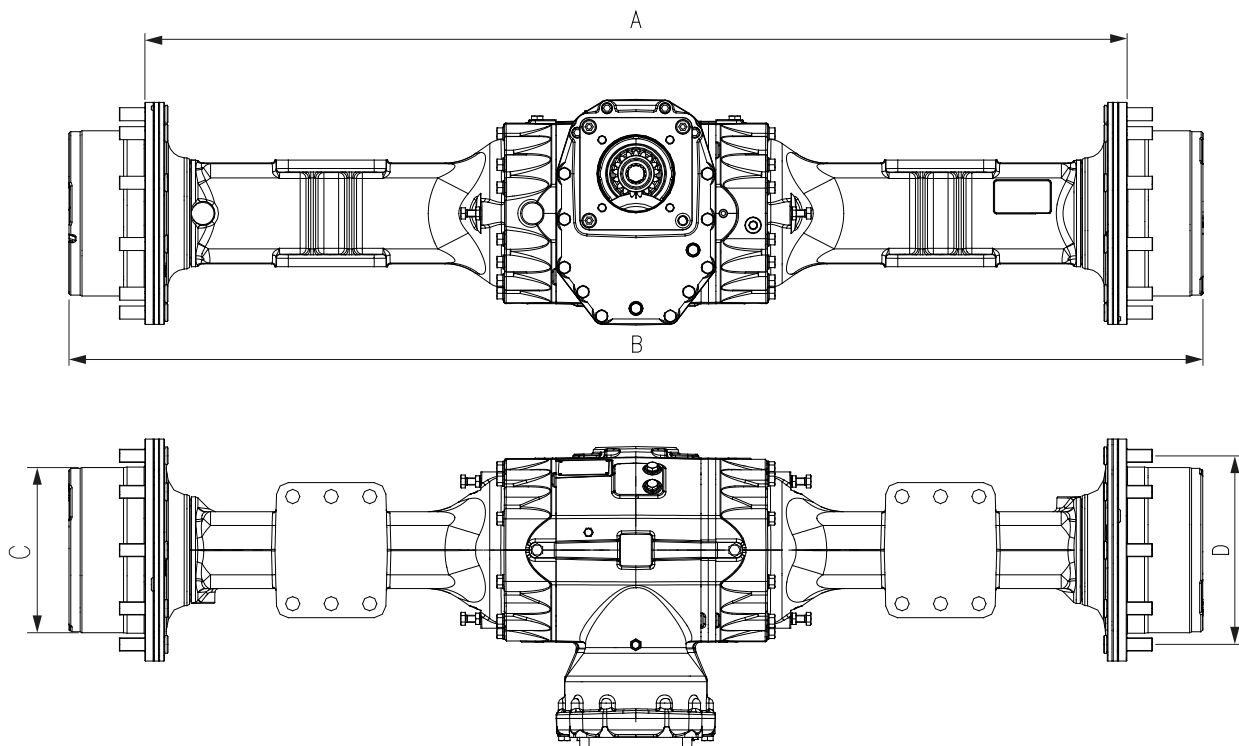

Technical Data		Installation Dimensions (mm)	
Dropbox Ratios	1:2.12	A - Flange to Flange	1,660
Planetary Reduction Ratio	1:6,000	B - Planetary Hub Length	1,916
Bevel Set Ratio	1:7,167	C - Wheel Pilot Diameter	280
Maximum Output Torque (Nm)	3,500	D - Wheel Bolt Circle Diameter	335
Load Capacity (daN); Static	16,000		
Load Capacity (daN); Dynamic	8,000		

Design Features	
Axle Mounting	Rigid Mounting on Axle Housing
Input Flange Option	Hydrostatic Motor
Service Brake	None
SAHR Brake	Internal
Differential Options	No Spin, Limited Slip 45%

Dana.com/oh/contact

Application Policy
Capacity ratings, features, and specifications vary depending upon the model and type of service. Application approvals must be obtained from Dana; contact your representative for application approval. We reserve the right to change or modify our product specifications, configurations, or dimensions at any time without notice.



SPICER®
Drivetrain Systems